

Project Setting

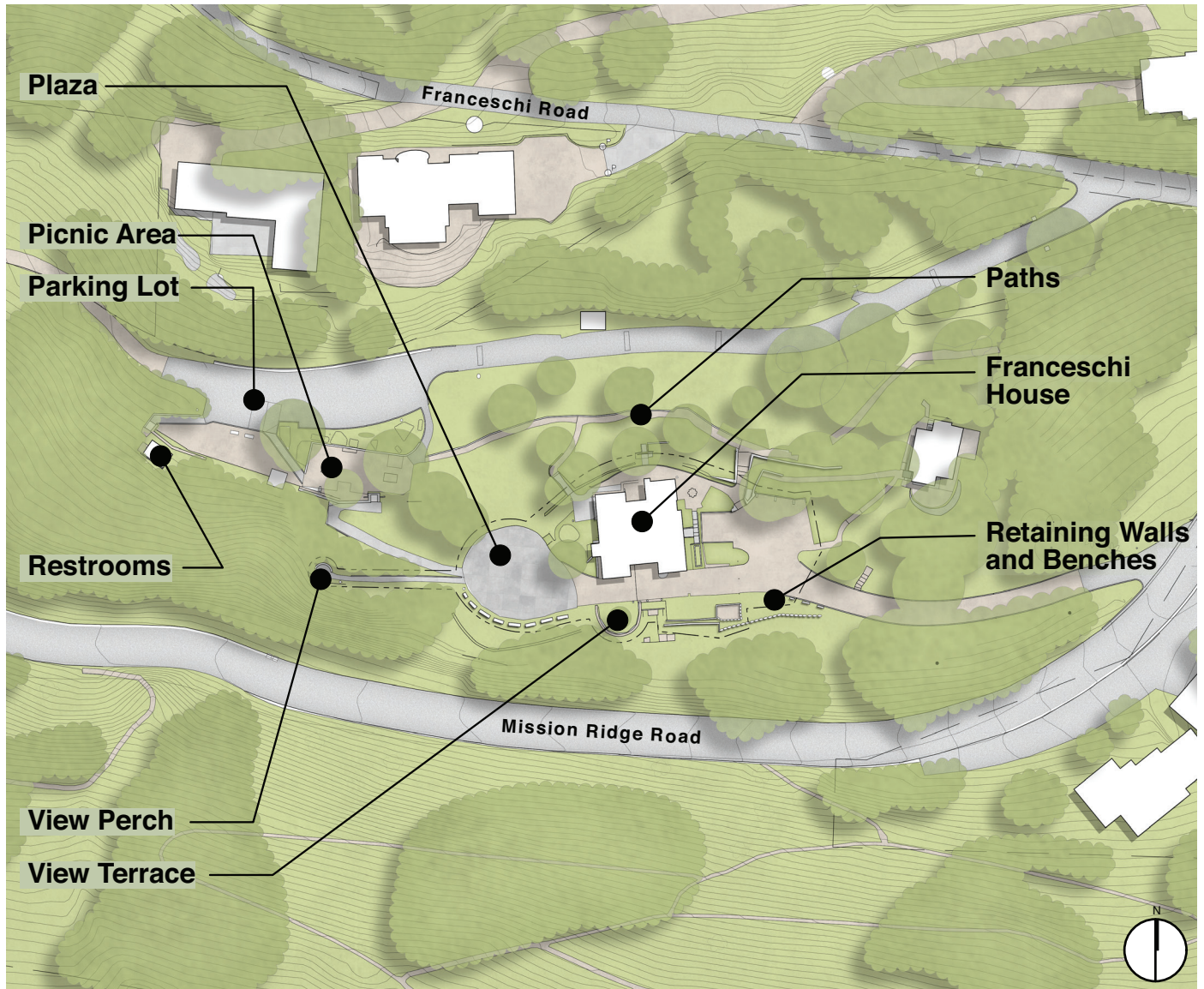

The Project Site is comprised of the Franceschi House and surroundings

Franceschi Park comprises 17 acres of City day use parkland near the top of the Riviera, in the foothill area above Santa Barbara. The grounds are located above and below Mission Ridge Road. The Franceschi House was designated a Structure of Merit by the City of Santa Barbara in 1981. The site has spectacular panoramic views overlooking the city, waterfront, and the Channel Islands. The site is a regular destination for the neighbors who hike onto the property, with occasional use by other residents of the city and tourists who come for the exceptional views.

The hilltop site which makes Franceschi Park so interesting, also makes it hard to reach and difficult to meander around. The Park and adjacent neighborhood are also located within a high fire risk area. The existing house and site features have fallen into disrepair, which is aggravated by the unstable soils. Very few specimen plantings and trees from the Franceschi-era remain, and there is limited funding available for maintenance.



Project Objective: To reimagine the Franceschi House and surrounding area to honor its heritage, Dr. Franceschi's horticultural legacy and Alden Freeman, while improving accessibility, safety, and resiliency.



Attributes:

- Views
- Landscape
- Pathways
- Parking
- Historical significance
- Unique features

Constraints:

- Limited access to & within the site
- Dilapidated structures & site features
- Steep slopes & erosive soils
- Limited funds for maintenance

Opportunities:

- Improve site access & safety
- Enhance views
- Honor heritage
- Increase wildfire resiliency

